



## NOZZLES

### TYPE V-SEAM NOZZLE WITH CLIP

#### CAN BE COMBINED WITH

280 ml, 290 ml, 300 ml and 310 ml Fischbach cartridges

#### ADVANTAGEOUS FEATURES

- > suitable for many applications
- > designed as a V-shaped application strand
- > good mechanical handling possible, especially on fully automatic filling lines
- > with nozzle clip for automatic adaptation to the cartridge beneath the cartridge thread

#### TECHNICAL SPECIFICATION

Material: HDPE  
 Weight: 2,6 g  
 Packaging unit: 2500 pcs./box

General tolerance:  
 DIN 16 901-150. Subject to technical changes.  
 Our product recommendations are based on empirical data only and cannot replace the customer's own tests.

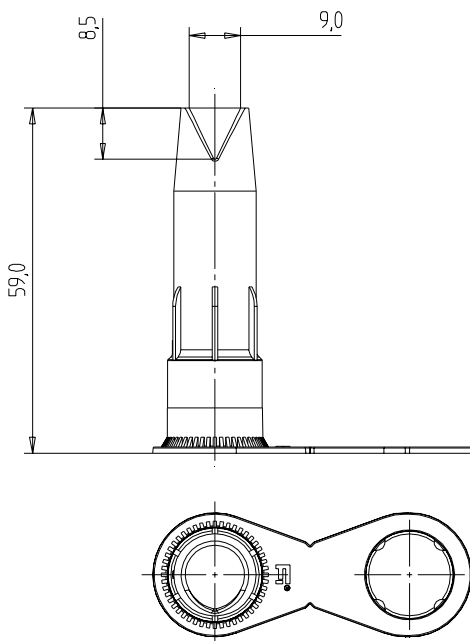

**Fischbach KG**  
 51766 Engelskirchen, Germany  
 Telefon: +49 (0) 2263 6090 T  
[info@fischbach-fi.com](mailto:info@fischbach-fi.com)

**Fischbach Korea Co., Ltd.**  
 Songpa-Gu, Seoul, Korea  
 Telefon: +82 2 425 3092  
[korea@fischbach-fi.com](mailto:korea@fischbach-fi.com)

**Fischbach Ibérica, S.A.**  
 17410 Sils (Girona), Spain  
 Telefon: +34-972-16 84 87  
[spain@fischbach-fi.com](mailto:spain@fischbach-fi.com)

**Fischbach (Shanghai) Co., Ltd.**  
 Shanghai, China 201708  
 Telefon: +86-21-6979-1423  
[china@fischbach-fi.com](mailto:china@fischbach-fi.com)

**Fischbach Belgium N.V.**  
 9140 Temse, Belgium  
 Telefon: +32-3-710 96 20  
[belgium@fischbach-fi.com](mailto:belgium@fischbach-fi.com)

**Fischbach U.K. Ltd.**  
 Cheshire WA7 1SN, Great Britain  
 Telefon: +44-1928-579320  
[uk@fischbach-fi.com](mailto:uk@fischbach-fi.com)

**Fischbach USA Inc.**  
 Elizabethtown, Kentucky, 42701  
 USA  
 Telefon: +1-270-7 69 93 33  
[usa@fischbach-fi.com](mailto:usa@fischbach-fi.com)

[www.fischbach-fi.com](http://www.fischbach-fi.com)